

PoolRaptor

Robotic swimming pool cleaner

HJ3012-30



MANUAL

Contents

1. Introduction	9
2. Important Precautions	9
3. Safety.....	10
4. Specifications.....	11
5. Operation instructions	11

1. INTRODUCTION

The robotic pool cleaner HJ3012 (with smart phone app) is a new type of highly efficient and energy-saving swimming pool cleaning robot. Through its advanced computer controlled program, it can clean the pool walls and bottom automatically. At the same time, it filters the pool water and gets rid of suspended particles from the pool bottom.

For safe operation, the cleaner works on 24V direct current.

Please read this user manual carefully before use.

2. IMPORTANT PRECAUTIONS

1. In order to prevent severe damage to the cleaner, never power on the unit when it is outside of the swimming pool.
2. The power cord must be connected to an appropriate earthed socket.
3. Do not operate the cleaner when people are in the pool.
4. Hold the top handle when putting the cleaner into the water or lifting it out of the water. Do not pull the cable.
5. Before powering on, make sure to empty the trapped air inside the cleaner (until no more air bubbles are coming from the cleaner and the cleaner is fully submerged on to the pool bottom).
6. Before powering on, make sure the filter are assembled and in position, and the cable are fully released to avoid any winding, which could affect the cleaner's performance or cause damage.
7. Please always clean and wash the filter bag after use.
8. The cleaner should be stored in a cool and ventilated place, away from direct sunlight when not in use.
9. The power supply unit should be placed in a shaded area during operation. In order to avoid overheating and potential damage of components, never cover up the power supply unit.
10. Only authorized service personnel are allowed to open the cleaner's power supply unit and motor assembly, otherwise the warranty will be invalidated.
11. Do not use the cleaner beyond the working environment/conditions stated in this manual.
12. After powering off the machine, you must wait at least 30 seconds to restart it.

13. Different densities of the filter net are needed for different seasons. For more details please contacts your local distributor.
14. This machine is only for cleaning the pool. Not for other purpose.
15. In case of the leaking from the oil seal, it may cause minor pollution.

IMAGE 1

When you put the cleaner into the water, please hold the top handle and make sure to empty the trapped air inside. The cleaner will then sink to the pool floor.



IMAGE 2

When pulling the cleaner out of the water, leave the cleaner hanging above water for about 10-15 seconds to empty the water inside. Please hold the top handle only, never pull the cable.

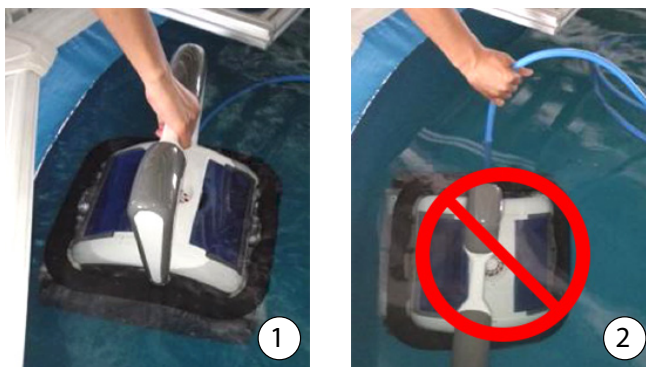

3. SAFETY

3.1 POWER SUPPLY UNIT POSITION

The power supply unit needs to be placed in the proper position for the cleaner to reach the distant end of the pool, meanwhile as least 3.5 m from the pool edge. In an oval / rectangular pool the power supply should be placed in the center of one of the long sides.

IMPORTANT

Before power on, make sure local voltage/frequency matches the rated voltage/frequency of the cleaner

- *Rated input voltage: 220 V (230 V)*
- *Frequency: 50 Hz / 60Hz*

4. SPECIFICATIONS

1	Rated input voltage:	220 V (230 V)
2	Frequency:	50 Hz / 60Hz
3	Output voltage:	24V
4	Power:	200 W
5	Working cycle:	1 t / 2 t / 3 t
6	Cable length:	18 m
7	Roller length:	465 mm
8	Max cleaning area:	200 m ²

9	Flow rate:	20 m ³ /t
10	Filter net density:	180 um
11	Pool water temperature:	10-32 °C
12	Moving speed:	Max 12,5 m/min
13	IP grade:	Cleaner: IPX8 / Power supply unit: IPx5
14	Cleaner weight:	12,5 kg (uden kabel)





5. OPERATION

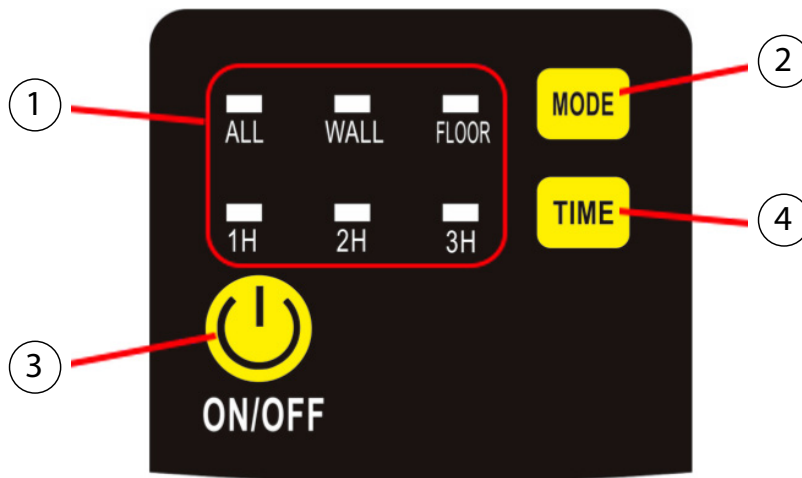

5.1 PANEL

IMAGE 3



NO.	SIGN	FUNCTION
1	INDICATOR	INDICATE THE MACHINE STATUS
	Two or three indicators on	Machine stopped
	1H flash slowly	Machine running for 1 hour
	2H flash slowly	Machine running for 2 hour
	3H flash slowly	Machine running for 3 hour
	ALL light on	Working under mode ALL
	WALL light on	Working under mode WALL

	FLOOR light on	Working under mode FLOOR
	ALL+ FLOOR light on	Working under mode ALL-FLOOR
	ALL >> WALL >> FLOOR flash in order	Manual: forward
	FLOOR >> WALL >> ALL flash in order	Manual: backward
	3H >> 2H >> 1H flash in order	Manual: left turn
	1H >> 2H >> 3H flash in order	Manual: right turn
	All lights flash slowly	Auto run finish
2	MODE OPTIONS	CHOOSE DIFFERENT MODE FOR DIFFERENT PURPOSE
	ALL	 <p>To clean the swimming pool floor and water line (once wall once floor)</p>
	WALL	 <p>To clean the swimming pool wall only</p>
	FLOOR	 <p>To clean the swimming pool floor only</p>
	ALL + FLOOR	 <p>To clean three times the swimming floor and one time the pool wall</p>
3	ON/OFF	SWITCH ON OR OFF
	Press this button	Machine will be switched on
	Press this button twice	Machine will work under selected mode
	Press this button third time	Machine will be switched off
4	TIME	WORKING DURATION OPTION
	1H	 <p>Machine runs for 1 hour</p>

2H			Machine runs for 2 hours
3H			Machine runs for 3 hours

5.2 DIAGNOSE

INDICATOR	FAULT	SUGGESTION
1H flash quickly with buzz	Machine out of water	Put machine back into water or wait until machine restart automatically
All lights flash quickly with buzz	Control box over load	Stop machine contact after sale service person
1H + 2H + 3H flash quick with buzz	Seal box leaking	Stop machine contact after sale service person
ALL + 1H flash quick with buzz	Pump over load	Stop machine check the impeller and pump
WALL + 2H flash quick with buzz	Walking motor 1 over load	Stop machine check belt and transmission system
FLOOR + 3H flash quick with buzz	Walking motor 2 over load	Stop machine check belt and transmission system
ALL + WALL + 1H + 2H flash quick with buzz	Cleaner present abnormal voltage	Stop machine contact after sale service person
ALL + WALL + FLOOR flash quick with buzz	Abnormal communication	Check the cable between cleaner and control box or contact the after sale service person
WALL + FLOOR + 2H + 3H flash quick with buzz	Machine out of water and could not restart	Stop machine restart machine manually after cleaner sink
WALL flash quick with buzz	Machine turned over	Turn over machine manually

5.3 BLUETOOTH FOR SMART PHONE

NR.	INDICATOR	FUNCTION
1	Bluetooth status	Disconnected / Connected
2	Searching signal	Press to start searching Bluetooth signal
3	▲	Manual walking forward
4	▼	Manual walking backward
5	◀	Manual left turn
6	▶	Manual right turn
7	Stop sign	Manual stop machine
8	Mode	<ul style="list-style-type: none"> Pool floor mode Pool wall mode One floor one wall mode Three floor one wall mode
9	Auto play or stop	Auto Play: working as selected mode Stop: stop working automatically

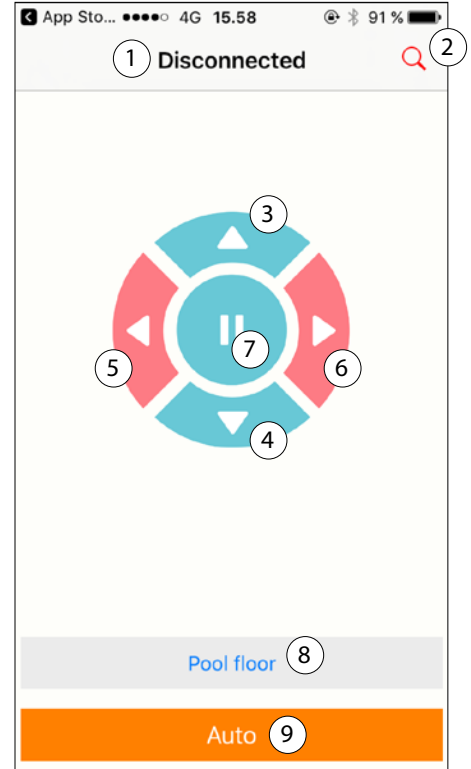

Attention: ◀ and ▶ need to be pressed constantly

5.4 CLEAN THE FILTER TRAY

IMAGE 4



1. Lift the handle

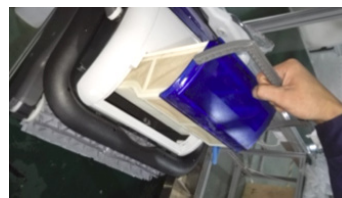

2. Lift the filter tray



3. Push towards the middle to open the filter tray

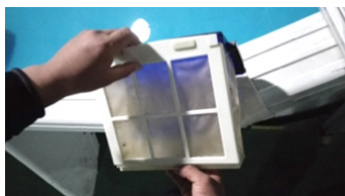

4. Move the filter panel outwards about 2 cm



5. Pull out the filter panel vertically



6. Rinse the filter



7. Slide the filter tray along the groove



8. Press the two ends of handle to fix with robot

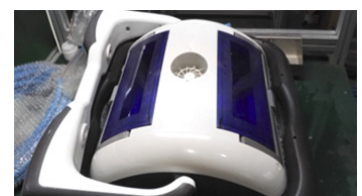

9. Two filter trays reassembled