

# REPLACEMENT PARTS

## Illustrated Parts List

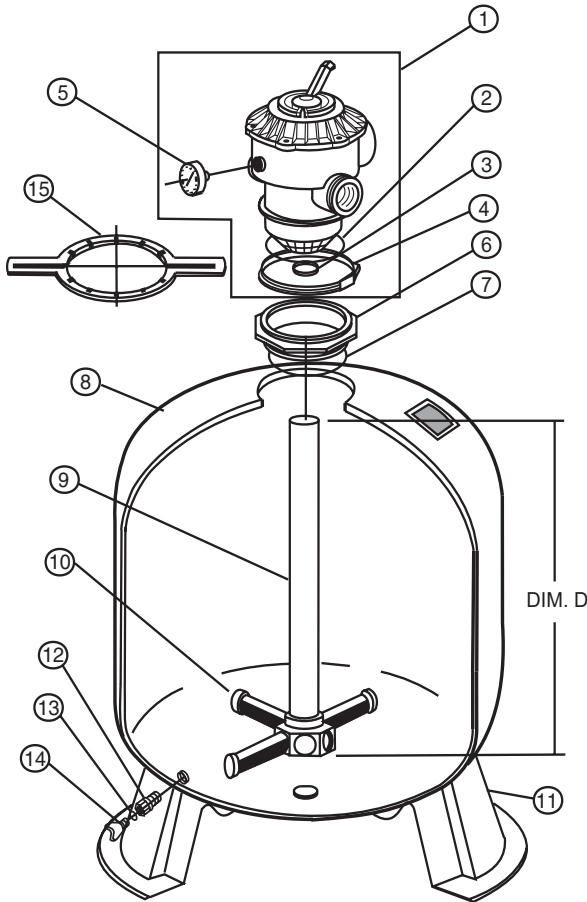

- |   |                   |
|---|-------------------|
| 1 | TA40 / TA40D      |
| 2 | TA50 / TA50D      |
| 3 | TA60 / TA60D      |
| 4 | TA100D            |
| 5 | TA60 (w/ClearPro) |

- NOTE 1:** Tank and filter assembly have valve adapter (Item 6) factory installed.
- NOTE 2:** Replacement of tank foot requires the use of mounting tape. See part number listed.
- NOTE 3:** Lubricate O-ring liberally w/ silicone lubricant and tighten to following spec:  
 40D, 50D, 60D Handtight plus ¼ turn min.  
 TA100D Handtight plus ¾ turn min.
- NOTE 4:** TA100D filters manufactured before December 1, 1993, have a different threaded operation on the filter tank and require a different 8½" adaptor, P/N 154521.

Item No.	Part No.	Description
1	262506	Valve, 1-1/2 in. 1 2 3
	261185	Valve, 2 in. 4
2	272541	O-ring, Valve Body, 3/16 in. X 4-3/4 in. I.D. 1 2 3
	275333	O-ring, Valve Body, 3/16 in. X 6-1/2 in. I.D. 4
3	355330	O-ring, Standpipe
4	152165	Clamp, 6-1/2 in. 1 2 3
	272619	Clamp, 8.35 in. 4
5	190059	Pressure Gauge
6	152520	Adapter, Quad Seal, 6 in. 1 2 3
	154521	Adapter, 8-1/2 in. (NOTES 3 & 4) 4
7	152517	O-ring, Valve Adapter 154555 & 154225 (9/17 or earlier) 1 2 3
	152516	Quad Ring, Valve Adapter 154520 (9/17 or newer) 1 2 3
	355619	O-ring, Valve Adapter, 1/8 in. X 8-1/4 in. I.D. 4
8	155276	Tank & Foot Assembly w/ Valve Adapter (NOTE 1) 1
	155279	Tank & Foot Assembly w/ Valve Adapter (NOTE 1) 2
	155269	Tank & Foot Assembly w/ Valve Adapter (NOTE 1) 3
	155324	Tank & Foot Assembly w/ Valve Adapter (NOTE 1) 4
9	151633	Piping Assembly (DIM. D = 18-4/5 in.) 1
	155334	Piping Assembly (DIM. D = 19-7/8 in.) 2
	155299	Piping Assembly (DIM. D = 22-5/8 in.) 3
	155340	Piping Assembly - Less Hub (DIM. D = 27-1/4 in.) 4
	155323	Piping Assembly - w/Hub (DIM. D = 27-1/4 in.) 4
10	150084	Lateral, 6 req. 1
	150085	Lateral, 6 req. 2 3
	152202	Lateral, 6 req. 4
	150088	Lateral, 6 req. 5
11	154926	Tank Foot 1 2 3
	154596	Tank Foot (NOTE 2) 4
12	154698	Spigot, Sand Drain, 3/4 in. 1 2 3
	152220	Spigot, Sand Drain, 2 in. 4
13	192115	O-ring, Drain Plug 1/16 in. X 1/2 in. I.D.
14	357161	Drain Plug
15	154512	Wrench, 6-1/2 in. Across Flats 1 2 3
	151608	Wrench, 9 in. Across Flats 4
-	154402	Mounting Tape, Foot 1 2 3
-	154407	Mounting Tape, Foot 4
-	155051	Sand Guide
-	155281	Hub Assembly 4
	152222	Hub Assembly 1 2 3

If your filter was manufactured before November 1994, please call Pentair Technical Support at 1-800-831-7133 for correct replacement part numbers for your filter. The first 4 digits of the serial number indicate the month and year product was manufactured.