



Small but powerful, Colorful



NKP Peristaltic Pump

Has thin wall thickness pump tube;
Flow range: 5.2-60ml/min;
Small size and low power consumption;
Four colors for the customer to choose;
Suitable for intermittent working situations.



APPLICATION AREAS



Medical
Use with the equipment,
Liquid transfer,
Sample Plling



Chemical
Liquid transfer,
sample analysis
Filling



Printing & Packaging
Ink transfer,
Pipe cleaning,
recycling



Laboratory
Liquid packaging,
distribution,
Quantitative extraction
and Plling

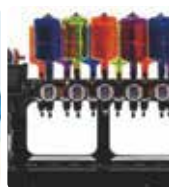

Food
Liquid-packing,
Plling



Environmental protection
Wastewater
sampling, transport



Factory
Micro-Flow liquid
packaging and
Plling



Smart Home
Water the Bowers,
potted landscape
irrigation

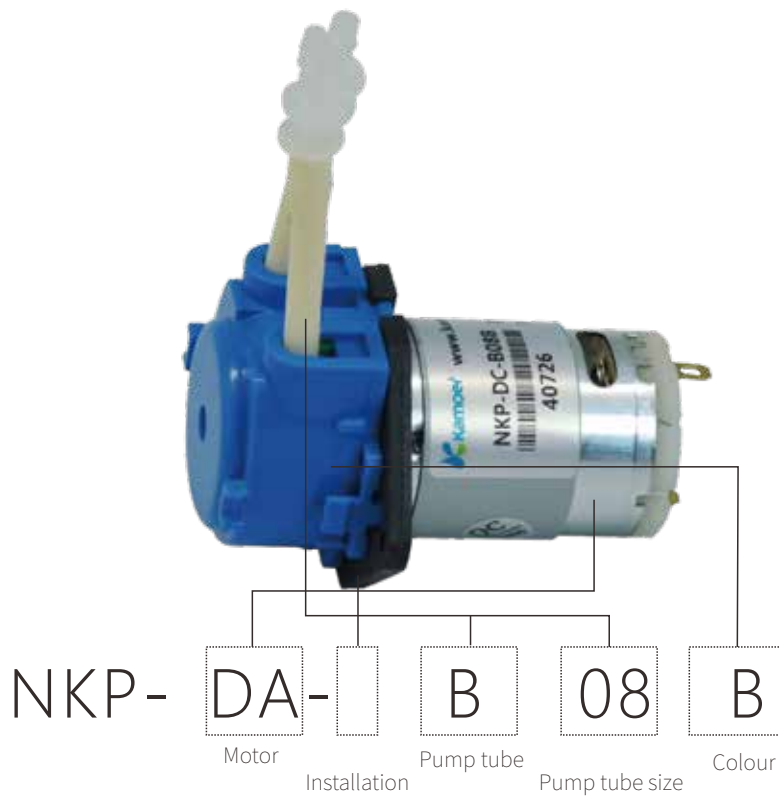

Flat plate
Unit: mm

L plate

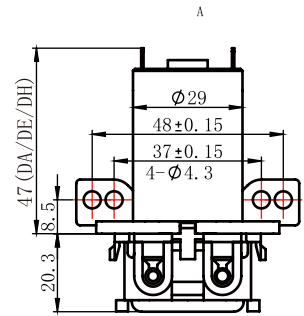
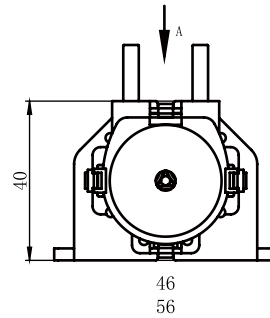
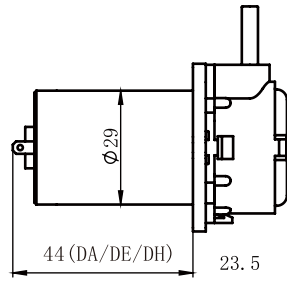
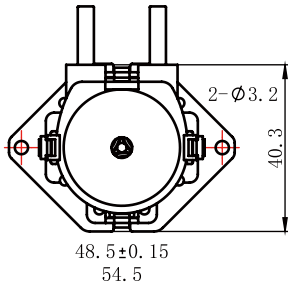

Performance parameter table

Code		S04	S06	S08	B06	B08
ID*OD (mm)		1x3	2x4	2.5x4.5	2x4	2.5x4.5
Pump tube material		S	S	S	BPT	BPT
Flow Rate (ml/min)	DA (24V) Current 0.15A	≥10	≥38	≥59	≥34	≥48
	DC (12V) Current 0.25A	≥10	≥37	≥55	≥33	≥47
	DE (6V) Current 0.35A	≥10.5	≥36	≥60	≥38	≥48

Technical parameter

Pump tube length:135mm(Exposed29.5mm)Codenamed B tube; 175mm(Exposed49.5mm)Codenamed S tube

Working conditions: Temperature 0~40°C ; Humidity: <80%

Weight:110g

Note: the above test data of new KP is measured at 20 °C at room temperature pure water under no pressure until the pump tube crack. Actual service life is related with medium, condition, temperature, humidity, voltage, speed and other factors, the measured data as a reference