



PVC pressure fittings

Male/male nipples ITEM 017



Ref.	Description	Net Weight	Vol. (m ³)	Gross Weight	Units Box
1002401	NIPPLE MALE-MALE 1/2"-1/2"	0.014	0.00472	1.49	100
1002402	NIPPLE MALE-MALE 3/4"-3/4"	0.020	0.00892	2.19	100
1002403	NIPPLE MALE-MALE 1"-1"	0.040	0.01553	4.33	100
1002404	NIPPLE MALE-MALE 1 1/4"-1 1/4"	0.054	0.02244	5.88	100
1002405	NIPPLE MALE-MALE 1 1/2"-1 1/2"	0.071	0.02244	7.54	100
1002406	NIPPLE MALE-MALE 2"-2"	0.125	0.02244	6.74	50
1002407	NIPPLE MALE-MALE 2 1/2"- 2 1/2"	0.171	0.03129	5.71	30
1002408	NIPPLE MALE-MALE 3"-3"	0.240	0.01553	2.89	10
1002409	NIPPLE MALE-MALE 4"-4"	0.410	0.01553	2.79	6

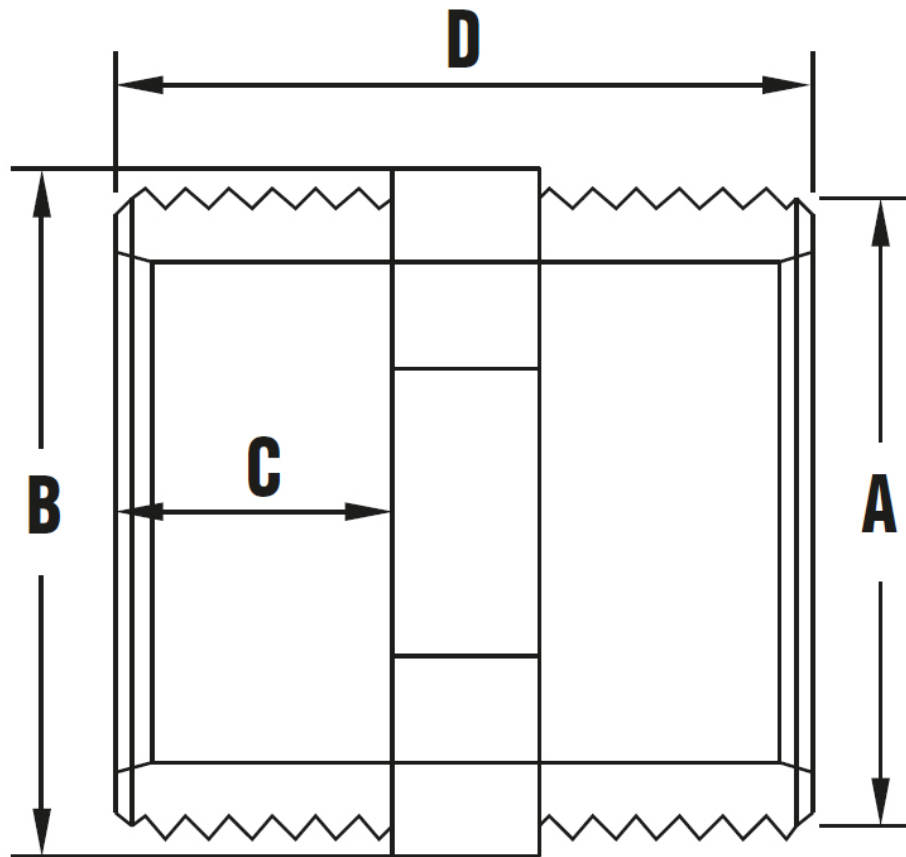

ITEM 017 | Male/male nipples

Codigo	A	Peso (g)	B	C	D	PN	ROSCA
02401	1/2"	14	29	11	40	PN10	BSP
02402	3/4"	21	34	16	44	PN10	BSP
02403	1"	37	44	19	50	PN10	BSP
02404	1 1/4"	54	50	21	55	PN10	BSP
02405	1 1/2"	71	60	22	57	PN10	BSP
02406	2"	108	70	26	65	PN10	BSP
02407	2 1/2"	175	80	31	75	PN10	BSP
02408	3"-3"	320	108	33	81	PN10	BSP
02409	4"-4"	510	135	38	91	PN10	BSP

