

## **6 - TERMS OF THE WARRANTY :**

As the original purchaser of this equipment has purchased from Emaux Water Technology Co Ltd, through Authorized International Distributor or Dealer, warrants its products free from defects in materials and workmanship under normal use during the warranty period. The warranty period begins on the day of purchase and extends only to the original purchaser. It is not transferable to anyone who subsequently purchases the product from you. It excludes all expendable parts.

During the warranty period, Emaux authorized reseller will repair or replace defective parts with new parts or, at the option of Emaux, serviceable used parts that are equivalent or superior to new parts in performance.

This Limited Warranty extends only to products purchased from Emaux authorized resellers. This Limited Warranty does not extend to any product that has been damaged or rendered defective.

- (a) as a result of an accident, misuse, or abuse;
- (b) as a result of an act of God;
- (c) by operation outside the usage parameters stated herein;
- (d) by the use of parts not manufactured or sold by Emaux;
- (e) by modification of the product;
- (f) as a result of war or terrorist attack; or
- (g) as a result of service by anyone other than Emaux authorized reseller or authorized agent.

EXCEPT AS EXPRESSLY OUTLINED IN THIS WARRANTY, EMAUX MAKES NO OTHER WARRANTIES EXPRESSED OR IMPLIED, INCLUDING ANY IMPLIED WARRANTIES OF MERCHANTABILITY AND FITNESS FOR A PARTICULAR PURPOSE. EMAUX EXPRESSLY DISCLAIMS ALL WARRANTIES NOT STATED IN THIS LIMITED WARRANTY. ANY IMPLIED WARRANTIES THAT MAY BE IMPOSED BY LAW ARE LIMITED TO THE TERMS OF THIS EXPRESS LIMITED WARRANTY.



## **MAIN DRAIN**

## **MANUAL INSTALLATION .**

### **MODELS :**

EM2837  
EM2838  
EM2839  
EM2840

## MAIN DRAIN

Model :EM2837 EM2838 EM2839 EM2840  
Codes :91600514 91600515 91600516 91600517

**IMPORTANT :** This instruction manual includes essential information on the safety measures to be implemented for installation and start up . Therefore the installer as well as the user must read the instructions before starting installation and startup .  
**Keep this manual for future reference**

### 1 .-MAIN DRAIN :

Main drains are used to take out water from the deepest part of the pool for the recirculation process . It is also used to drain the pool .Fig 1 )

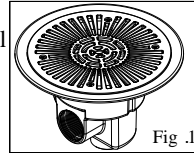

### 2 .-INSTALLATION :

According to the normative main drains have to be installed asfollowing :

- Main drains have to be installed in the deepest part of the pool .
- The minimum distance between two main drains is 2 meters .
- The minimum distance between the main drain and the wallof the pool is 300 mm .
- The maximum water velocity through the grille is 0.5 m /sec .
- The maximum water velocity in the suction pipe until the filtration pump is 1.5 m /sec .

The flow rate required for the installation will determine the number of main drains needed . The maximum flow rate allowed is 13 m<sup>3</sup> /h .

### 3 .-MODELS :

		Concrete pools		Vinyl pools with Liner	
		EM2838	EM2839	EM2837	EM2840
Metric connections	Suction Circuit	G2"		G2 "	
	Hydrostatic valve connection *	50 mm		50 mm	
Imperial connections	Suction Circuit	G2"		G2"	
	Hydrostatic valve connection *	1 ½"		1 ½"	

\*Emaux Water Technology Co .Ltd recommends to install a hydrostatic valve (not included ) on the lower outlet of the main drain (BSP thread 1 ½" ) in order to relieve the pressure that potential ground water might exert on the pool structure especially when it is empty or it is Vinyl pool .

### 4 .-WARNINGS :SUCTION ENTRAPMENT HAZARD .

Suction in suction outlets and for suction outlet covers which are damaged ,broken ,cracked , missing ,or unsecured can cause severe injury or death due to the following entrapment hazards :

- 4.1 .-Hair Entrapment -Hair becomes knotted or snagged in an outlet cover .
- 4.2 .-Limb Entrapment -A limb sucked or inserted into an opening of a circulation outlet with a broken or missing cover in the pool resulting in a mechanical bind or swelling

4.3 .-Body Suction Entrapment -Suction applied to a large portion of the body or limbs resulting in an entrapment .

4.4 .-Mechanical Entrapment -Potential for jewelry swimsuit hair decorations finger , toe or knuckle to be caught in an opening of an outlet or cover .

### 5 .-SPARE PARTS LIST :

POS	CODE	PRODUCT DESCRIPTION
1	03012109	Screws M5x24
2	01050195	Lid
3	03012110	Screws M6x24
4	01050196	Facering
5	02010278	Liner gaskets
6	01050197	Body

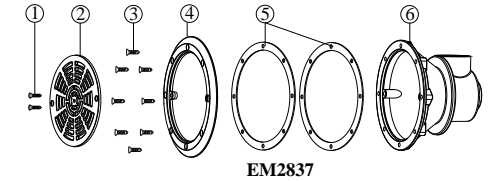

POS	CODE	PRODUCT DESCRIPTION
1	03017125	Screws M5x10
2	01050195	Lid
3	01050198	Body

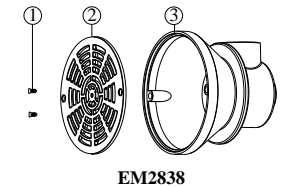

POS	CODE	PRODUCT DESCRIPTION
1	03012108	Screws M5x30
2	01050199	Lid
3	01050200	Body

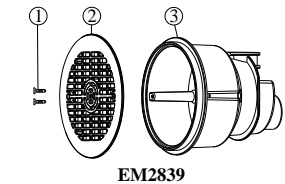

POS	CODE	PRODUCT DESCRIPTION
1	03012111	Screws M5x45
2	01050199	Lid
3	03011322	Screws M5x25
4	01050201	Facering
5	02010282	Liner gaskets
6	01050202	Body

