

## **5 - TERMS OF THE WARRANTY :**

As the original purchaser of this equipment has purchased from Emaux Water Technology Co Ltd, through Authorized International Distributor or Dealer, warrants its products free from defects in materials and workmanship under normal use during the warranty period. The warranty period begins on the day of purchase and extends only to the original purchaser. It is not transferable to anyone who subsequently purchases the product from you. It excludes all expendable parts.

During the warranty period, Emaux authorized reseller will repair or replace defective parts with new parts or, at the option of Emaux, serviceable used parts that are equivalent or superior to new parts in performance.

This Limited Warranty extends only to products purchased from Emaux authorized resellers. This Limited Warranty does not extend to any product that has been damaged or rendered defective.

- (a) as a result of an accident, misuse, or abuse;
- (b) as a result of an act of God;
- (c) by operation outside the usage parameters stated herein;
- (d) by the use of parts not manufactured or sold by Emaux;
- (e) by modification of the product;
- (f) as a result of war or terrorist attack; or
- (g) as a result of service by anyone other than Emaux authorized reseller or authorized agent.

EXCEPT AS EXPRESSLY OUTLINED IN THIS WARRANTY, EMAUX MAKES NO OTHER WARRANTIES EXPRESSED OR IMPLIED, INCLUDING ANY IMPLIED WARRANTIES OF MERCHANTABILITY AND FITNESS FOR A PARTICULAR PURPOSE. EMAUX EXPRESSLY DISCLAIMS ALL WARRANTIES NOT STATED IN THIS LIMITED WARRANTY. ANY IMPLIED WARRANTIES THAT MAY BE IMPOSED BY LAW ARE LIMITED TO THE TERMS OF THIS EXPRESS LIMITED WARRANTY.



## **FLOOR RETURN INLETS**

### **MANUAL INSTALLATION .**

#### **MODELS :**

EM2861(A) / EM2861(E)  
EM2861(A1) / EM2861(E1)  
EM2862(A) / EM2862(E)  
EM2863(A) / EM2863(E)

## FLOOR RETURN INLETS

**IMPORTANT :** This instruction manual includes essential information on the safety measures to be implemented for installation and start up .Therefore the installer as well as the user must read the instructions before starting installation and startup .

Keep this manual for future reference

### 1.-FLOOR RETRN INLET :

Return inlets are one of the most important pool fittings for a proper water recirculation .

Two different models of return inlets are available Wall return and Floor return inlets.

Wall return inlets are specially designed for those pools with skimmers ,since the water recirculation in the pool is "horizontal" from the inlets to the skimmers .

On the other hand ,the Floor return inlets are recommended to be installed in swimming pools with overflow channel .They prevent dirt from settling by lifting it towards the overflow , creating a "vertical" recirculation .

### 2.-INSTALLATION :

The positioning of the Floor return inlets is important in order to obtain a proper water recirculation and avoid any zone in the pool where water is not circulated periodically. The total flow rate will determine the number of inlets needed. Each Floor return inlet allows a water flow rate of 12 m<sup>3</sup>/h. However, the flow rate can be adjusted by screwing or unscrewing the central bolt (Fig. 1).

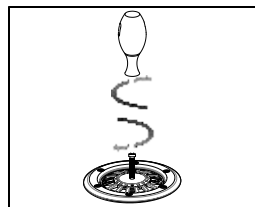

Fig 1

Models **EM2861** and **EM2862** are designed for concrete pools (Fig 2 ).

Model **EM2863** is available for Vinyl and Liner pools (Fig 3):

Ø For Vinyl pools with liner ,install both two joints one behind the vinyl pool and the other behind the liner .It is recommended to install the wall conduit model **EM2842** .

For concrete pools with liner ,install the Floor return inlet with only one joint .It is recommended to install the wall conduit model **EM2841** .

### 3.-CONNECTIONS :

	EM2861	EM2862	EM2863
Type of pool	Concrete pools	Concrete pools	Vinyl or Liner pools
Metrical connections	Pipe 63 mm PN10 (EM2861E)	Pipe 50 mm ; Screwthread 2"	Pipe 50 mm ; Screwthread 2"
	Pipe 63 mm PN16 (EM2861E1)		
Imperial connections	Pipe 2" Class 12 (EM2861A)	Pipe 1 1/2" ; Screwthread 2"	Pipe 1 1/2" ; Screwthread 2"
	Pipe 2" Class 15 (EM2861A1)		

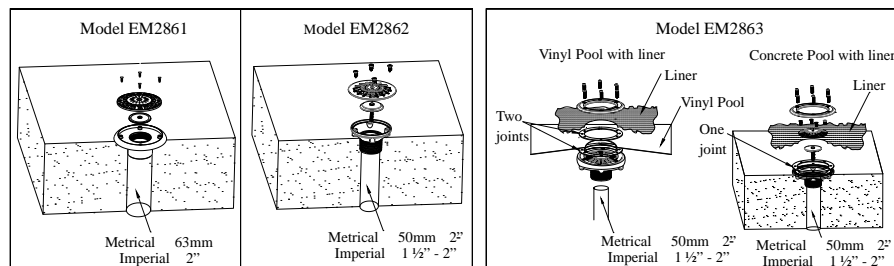
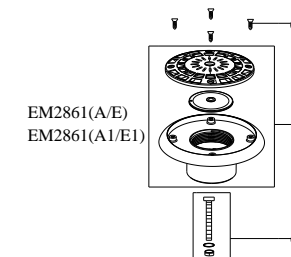

Fig 2

Fig 3

### 4.-SPARE PARTS LIST :

POS .	CODE	PRODUCT DESCRIPTION
1	03012112	Screws
2	89140515	Body GB63 PN10 (EM2861E)
2	89140516	Body BS 2" Class 12 (EM2861A)
2	E160805	Body GB63 PN16 (EM2861E1)
2	E160804	Body BS 2" Class 15 (EM2861A1)
3	89140517	Flow regulator screw



POS .	CODE	PRODUCT DESCRIPTION
1	03011018	Screws M5x20
2	89140502	Lid with flow regulator
3	02010277	O-ring
4	01050208	Body GB50
4	01050215	Body BS 1.5"

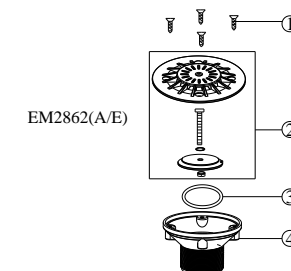

POS .	CODE	PRODUCT DESCRIPTION
1	03012109	Screws M5x24
2	01050209	Face ring
3	02010279	Liner gaskets
4	03011003	Screws M4x12
5	01011333	Screws M5x15
6	89140506	Lid and flow regulator
7	02010277	O-ring
8	01050210	Body GB50
8	01050217	Body BS 1.5"

